

BASES MÚLTIPLES Y PROLONGADORES
MULTIPOINT SOCKETS & EXTENSIONS
MULTIPLES PRISES ET EXTENSIONS
BASES MÚLTIPLAS E PROLONGADORES
SERIE 8000

1 Vista general:

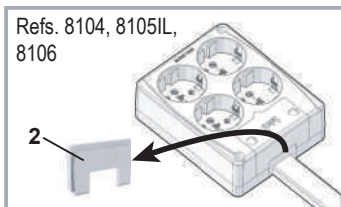

www.psolera.com

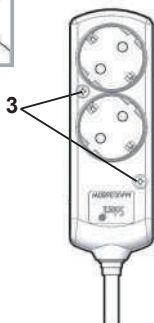
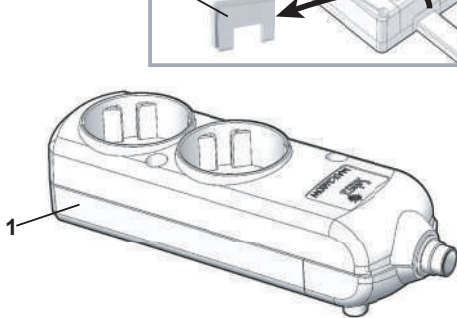

2 Normativa:

- Siga estas instrucciones para cumplir con los reglamentos de baja tensión R.D. 842/2002.
- La instalación, servicio y mantenimiento de los equipos eléctricos y electrónicos solo pueden ser realizados por una persona autorizada.

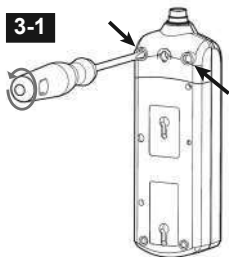
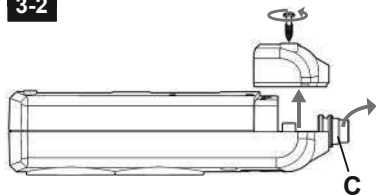
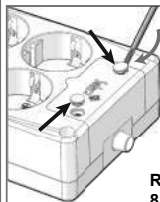
3-1**3-2****3-1B**

Refs. 8104,
8105IL, 8106

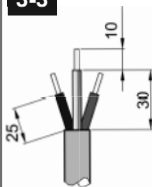
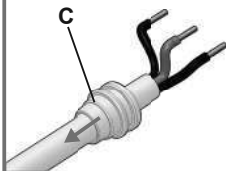
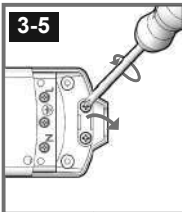
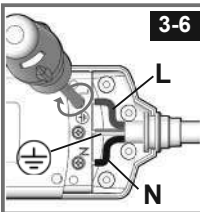
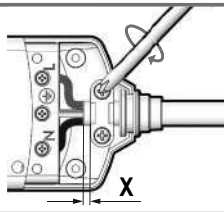
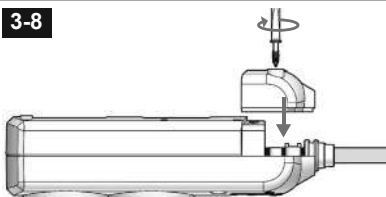
3-3**3-4****3-5****3-6****3-7****3-8**

4-1

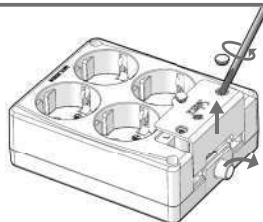

4-2

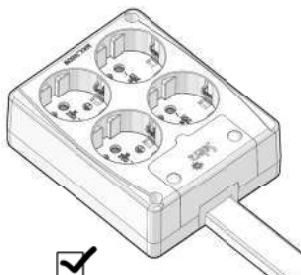
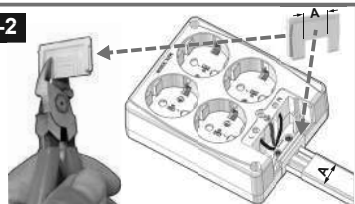

5-1

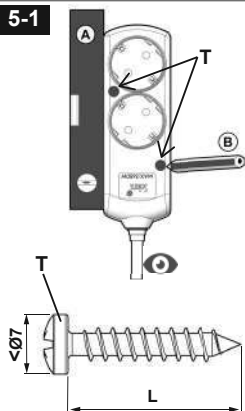

Refs.	L (min.)
8104, 8105IL, 8106.	15 mm.
RESTO (OTHERS)	30 mm.

5-2

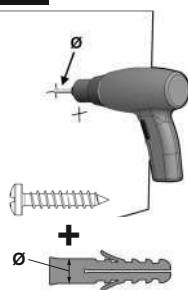

5-3

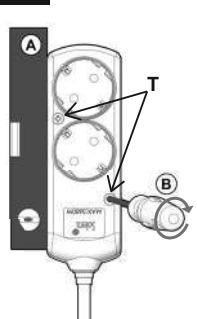

Gestión de residuos de envases y de productos:

RESIDUOS DE ENVASE				RESIDUOS DE PRODUCTOS		
MATERIAL	DEPOSITAR EN:	LOGOTIPO EN ESPAÑA	LOGOTIPO INTERNACIONAL	RESIDUOS	DEPOSITAR EN:	LOGOTIPO
PLÁSTICO	CONTENEDOR AMARILLO			RAEE	PUNTO DE VENTA	
PAPEL Y CARTÓN	CONTENEDOR AZUL					

NOTA: El color de los contenedores puede variar en función del país donde se aplique. Consulte la normativa local al respecto.

Consejos generales de seguridad y uso:



Instructions for use and safety

ENGLISH

1-General view:

2-Regulations:

-Follow these instructions to comply with R.D. low voltage regulations. 842/2002.

- The installation, service and maintenance of electrical and electronic equipment can only be carried out by an authorized person.

Management of packaging and product waste: PACKAGING WASTE; MATERIAL; PLASTIC; PAPER AND PAPERBOARD; DEPOSIT IN: (NOTE); LOGO IN SPAIN; INTERNATIONAL LOGO (NOTE); PRODUCT WASTE; WASTE; WEEE; DEPOSIT IN: SELLING POINT; LOGO. NOTE: The color of the containers may vary depending on the country where it is applied. Check local regulations on this.

Safety and usage tips. (QR code)

Mode d'emploi et de sécurité

FRANÇAIS

1. Vue d'ensemble:

2-Règlements :

-Suivez ces instructions pour vous conformer aux réglementations R.D. basse tension. 842/2002.

- L'installation, l'entretien et la maintenance des équipements électriques et électroniques ne peuvent être effectués que par une personne autorisée.

Gestion des emballages et des déchets de produits: DÉCHETS DES CONTENEURS; MATÉRIEL; PLASTIQUE; PAPIER ET CARTON; DÉPÔT EN: (REMARQUE); LOGO EN ESPAGNE; LOGO INTERNATIONAL (REMARQUE); DÉCHETS DE PRODUITS; DÉCHETS; DEEE; DÉPÔT EN: POINT DE VENTE; LOGO. REMARQUE: la couleur des contenants peut varier en fonction du pays où elle est appliquée. Vérifiez les réglementations locales à ce sujet.

Conseils généraux de sécurité et d'utilisation.
(QR Code)

Instruções de uso e segurança

PORTUGUÊS

1. Visão Geral:

2-Regulamento:

-Siga estas instruções para cumprir os regulamentos de baixa tensão R.D. 842/2002.

- A instalação, serviço e manutenção de equipamentos elétricos e eletrônicos só podem ser realizados por uma pessoa autorizada.

Gestão de embalagens e resíduos de produtos: RESÍDUOS DE RECIPIENTES; MATERIAL; PLÁSTICO; PAPEL E CARTÃO; DEPÓSITO EM: (NOTA); LOGO NA ESPANHA; LOGOTIPO INTERNACIONAL (NOTA); RESÍDUOS DE PRODUTOS; DESPERDÍCIO; REEE; DEPÓSITO EM: PONTO DE VENDA; LOGOTIPO.

NOTA: A cor dos recipientes pode variar dependendo do país onde é aplicado. Verifique os regulamentos locais sobre isso.

Dicas de segurança e uso. (Código QR)