

# SL-CP21C

## AC Contactor



### Function

SL-CP21C series AC contactor is suitable for using in the circuits up to rated voltage 660V, AC 50Hz or 60Hz, DC rated voltage 220V and rated current 12A in AC-3/380V load circuits, for remote control of circuit making and breaking. Combined with related type of thermal relay or electronic protector, it becomes the electromagnetic starter or mechanical interlocking starter.

### Normal Application and Installation Conditions

- Ambient temperature: the upper limit shall not exceed +40° C ; the lower limit shall be not less than -5° C ; the average value within 24 hours shall not exceed +35° C .
- Altitude: installation altitude shall not exceed 2000m.
- Atmosphere condition: relative humidity shall not exceed 50% when ambient temperature is +40° C . Higher relative humidity is permissible at lower temperature. The average temperature shall not exceed +25° C in the most humid month when the relative humidity shall not exceed 90%. Please consider the dew with the change of temperature.
- Anti-pollution degree: III
- Installation category: III
- Installation conditions: slant of contactor mounting surface shall not exceed ±5°.
- Shock: contactor can be installed and used in the place where with no notable shock, shake and impact.
- This product is made by full plastic snap fit structure and takes advantage of the elasticity of the plastic itself. It saves work and time and material as does not need the screw and special tool to mount or dismount.
- This product is horizontal moving mode with the feature of good moving reliability, flexible structure, compact design, external foreign matter and dust proof. It has a cover on the move part terminal for preventing from human finger touching, ensuring safe using and according with related electronic safe standard. The product is small volume which is convenient for mounting and dismounting by screw installation or 35mm din rail for installation.
- The contact of product is double break-bridging structure and is made of silver base alloy. It has following feature: good capability of electric conductivity, contact abrasion resistance, long service life. Arc extinguish chamber is close end type which is made by fire retardant material and could avoiding arc splashing to ensure human and near equipment safety.
- The magnetic system of the product is E-shape iron core which is good reliability, low consumption and low noisy. It has high mechanical strength. The terminal coil A1 and A2 are with very clear specification and convenient for wire connection.
- Modularity and building block system of auxiliary contact could assemble flexibly.

### Specification

(1) The contactor main technology property index, refer to the following form.

(2) The coil voltage of the contactor are AC 24V, 36V, 48V, 110V, 220V, 380V and DC 12V, 24V, 48V, 110V, 220V.

NOTE: please contact us for other coil voltage.

(3) Operating characteristic: AC pull-in voltage: 85%-110% Us, release voltage: 20%-75%Us, DC pick-up voltage: 85%-110%Us, release voltage: 10%-75%Us.

Parameter		Model	SL-CP21-06K	SL-CP21-09K	SL-CP21-12K	SL-CP21-06E	SL-CP21-09E
Rated voltage(V)			660(690)				
Rated current(A)	380V	AC-3	6	9	12	6	9
		AC-4	2.6	3.5	5	2.6	3.5
Agreed thermal current(A)			20	20	20	16	16
Max. making- current(A)	380V		60	90	120	60	90
	660V		72	108	144	72	108
Max. breaking-current(A)	380V		48	72	96	48	72
	660V		60	90	120	60	90
Controllable 3-phase squirrel- cage motor power AC3 (kW)	220V		1.5	2.2	3	1.5	2.2
	380V		2.2	4	5.5	2.2	4
	660V		3	5.5	7.5	3	5.5
Operation frequency (times/h)	Electrical life	AC-3	1200				
		AC-4	300				
Electrical life (10 <sup>4</sup> times)		AC-3	100				
		AC-4	20				
Mechanical life(10 <sup>4</sup> times)			1000				
AC coil consumed power(W)			2				
DC coil consumed power(W)			4				
Wire (mm <sup>2</sup> )			1.5				
Suitable fuse			NTOO-16				
Standard			IEC60947-4				

# SL-CP21R

## Thermal Relay



### Specifications

Setting range(A)	0.10~0.16 1.6~2.5	0.16~0.25 2.5~4	0.25~0.4 4~6	0.4~0.63 5.5~8	0.63~1 7~10	1~1.6 9~13
For contactor	EBS1C-K06/09 EBS1C-09 EBS1C-12 EBS1C-18					
Contactor parameter	I <sub>th</sub> =10A,1NO+1NC					

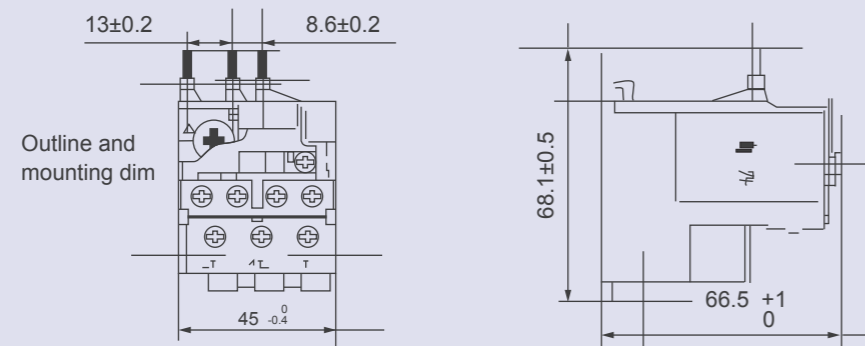

Relay setting range	Fuses to be used with selected relay	
	aM Type(A)	gG Type(A)
0.1~0.16	0.25	0.5
0.16~0.25	0.25	0.5
0.25~0.3	0.5	1
0.3~0.54	1	1.6
0.54~0.8	1	2
0.8~1.2	2	6
1.2~1.8	4	8
1.8~2.6	4	10
2.6~3.7	6	16
3.7~5.5	8	20
5.5~8	10	25
8~11.5	16	32



SL-CP21R  
3 Pins